



Your Cork Specialists

products

Products

Cork Info

Portfolio

Company

What's New

Contact Us

Home

WE Cork Inc.  
16 Kingston Road  
Exeter, NH 03833

## PRODUCTS: FLOOR UNDERLAYMENT

[Floor Tiles](#) • [Floating Floors](#) • [Underlayment](#) • [Sheets](#) • [Rolls](#) • [Expansion Joints](#)  
[Insulation Corkboard](#) • [Cork Stoppers](#) • [Gift / Utility Items](#)

## Cork Underlayment Installation Instructions

[Guidelines](#) || [Installation](#) || [WECU Characteristic](#) || [WECU 3 Part Spec.](#) || [Sound Ratings](#)

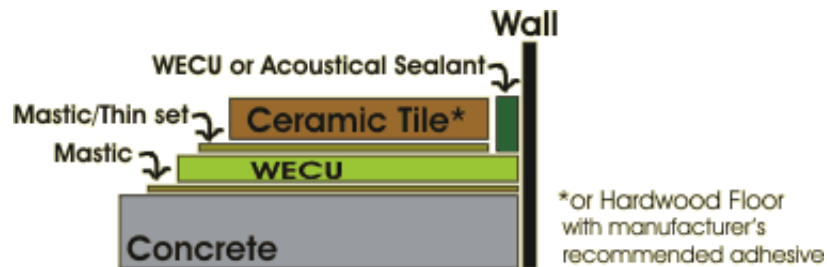

**MATERIALS CERAMIC TILE:** Larger than 4" x 4" tile

**THIN SET** (sanded): to meet ANSI A 118.4 for latex Portland Cement. All ceramic tile installation must conform to ANSI A108

**WECU:** WECU Crackless for stress crack suppression only, WECU Soundless for sound control for concrete structure with suspended ceiling; WECU Soundless+ for optimum sound control for concrete and wood joist structure with or without suspended ceiling.

**MASTIC:** for above grade indoor Installation use a ceramic tile mastic which conforms to ANSI A.136.1 TYPE 1 or a good quality indoor/outdoor carpet adhesive.

## APPLICATION

1. Subfloor must be structurally sound, level and clean.
2. Spread out mastic on subfloor with flat side of a 3/16- v-notched trowel to achieve good bond. Then, Use the notched side for a good bond to WECU.
3. Install WECU butting seams and up to walls snugly.



